

# Lassy Residence

## Summary - Porous Pavement System Reconfiguration

### 140 South Shore Drive

The porous pavement filter system approved in December of 2020 is proposed to be modified. Modifications consist of a reconfiguration of the layout to allow for circular use of the driveway, as had been in place prior to construction.

Reconfiguration adds 92 square feet to the porous surface.

The proposed filter system underlying the porous surface would not be altered in cross section but increased in area in the additional 92 square feet.

The final porous surface is proposed to be as approved and used on South Shore Drive two houses to the east of 140 South Shore Drive. The depth would be a minimum of 2-3 inches consisting of an open graded aggregate bituminous material. The reason for the modification in material is the enhanced performance of asphalt where there is a transition from one material to another. Winter snow removal operations along South Shore Road are for the entire length of the road. Transitions from block to asphalt are susceptible to damage from plows. A continuous asphalt corridor provides more protection from frost movement due to the viscoelastic nature of the material. Another benefit to using asphalt is the one-day disturbance to traffic versus multiple days with concrete pavers. When in service, there are no serious detrimental effects of asphalt pavement on water quality, anywhere. How could there be a million tons a year of asphalt placement in the State of Connecticut without any known water quality issue. There are no water quality issues I am aware of from using asphalt shingle roofing material.

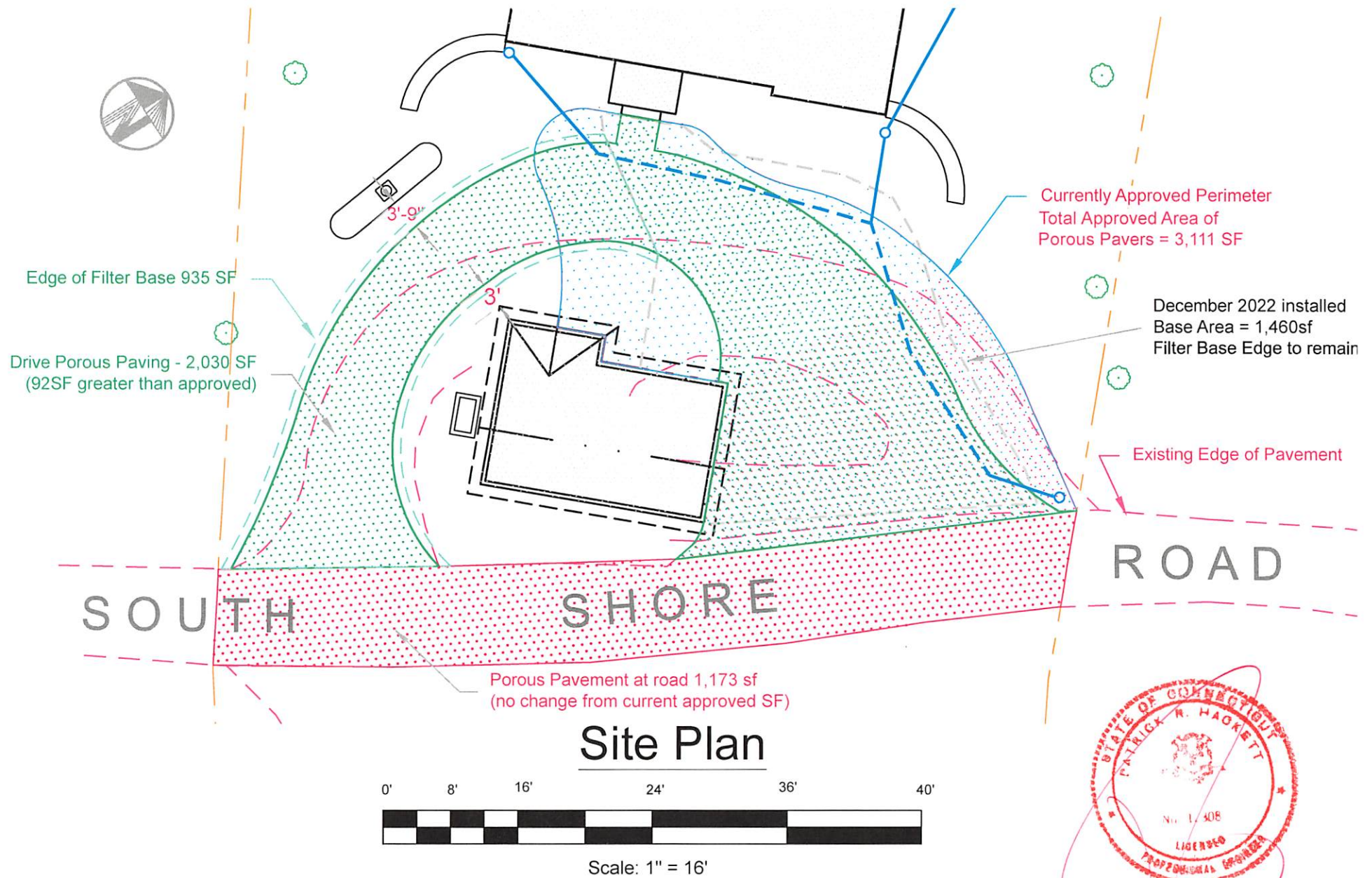

LASSY RESIDENCE  
140 SOUTH SHORE ROAD  
SALISBURY, CONNECTICUT

Date: January 20, 2023