

TOWN OF SALISBURY, CONNECTICUT
HISTORIC DISTRICT COMMISSION

APPLICATION FOR CERTIFICATE OF APPROPRIATENESS

Appl. No. 2024-001 Name of property FREYA BLOCK
Ctf. Issued _____ Ctf. No. _____ Property No. _____
Date Jan 16 2024

Application is hereby made for the issuance of a Certificate of Appropriateness under an "Ordinance Establishing Historic Districts within the Town of Salisbury", duly adopted on February 9, 1970 and enacted pursuant to the enabling authority contained in Sections 7-147(a) through 7-147(k) of the General Statutes of Connecticut, for the proposed work described below and as shown on the photographs, plans, or drawings (where applicable or appropriate), accompanying this application:

Address of proposed work 16 FURNACE ROAD, LAKEVILLE, CT
Owner FREYA BLOCK Owner's address 16 FURNACE ROAD, LAKEVILLE, CT
Applicant, if not owner DARYL D. GAWEL

Agent or contractor GAWEL CARPENTRY

Address 235 SALISBURY ROAD, CANAAN, CT 06018

Proposed work is in connection with: ☒ a dwelling; _____ an accessory building;
_____ a commercial building; _____ an industrial building; _____ other (specify)

Nature and description of proposed work (attach extra sheets as necessary);

REMOVE SINGLE PANE WINDOWS & MODERN STORM WINDOWS
AND REPLACE WITH MARVIN THERMAL WINDOWS WITH
SPCL GLASS. AND SCREENS.

Signature of Applicant Daryl D. Gawel
DARYL D GAWEL

Action taken:

Planning and Zoning Commission _____ Date _____

Building Inspector _____ Date _____

Historic District Commission _____ Date _____





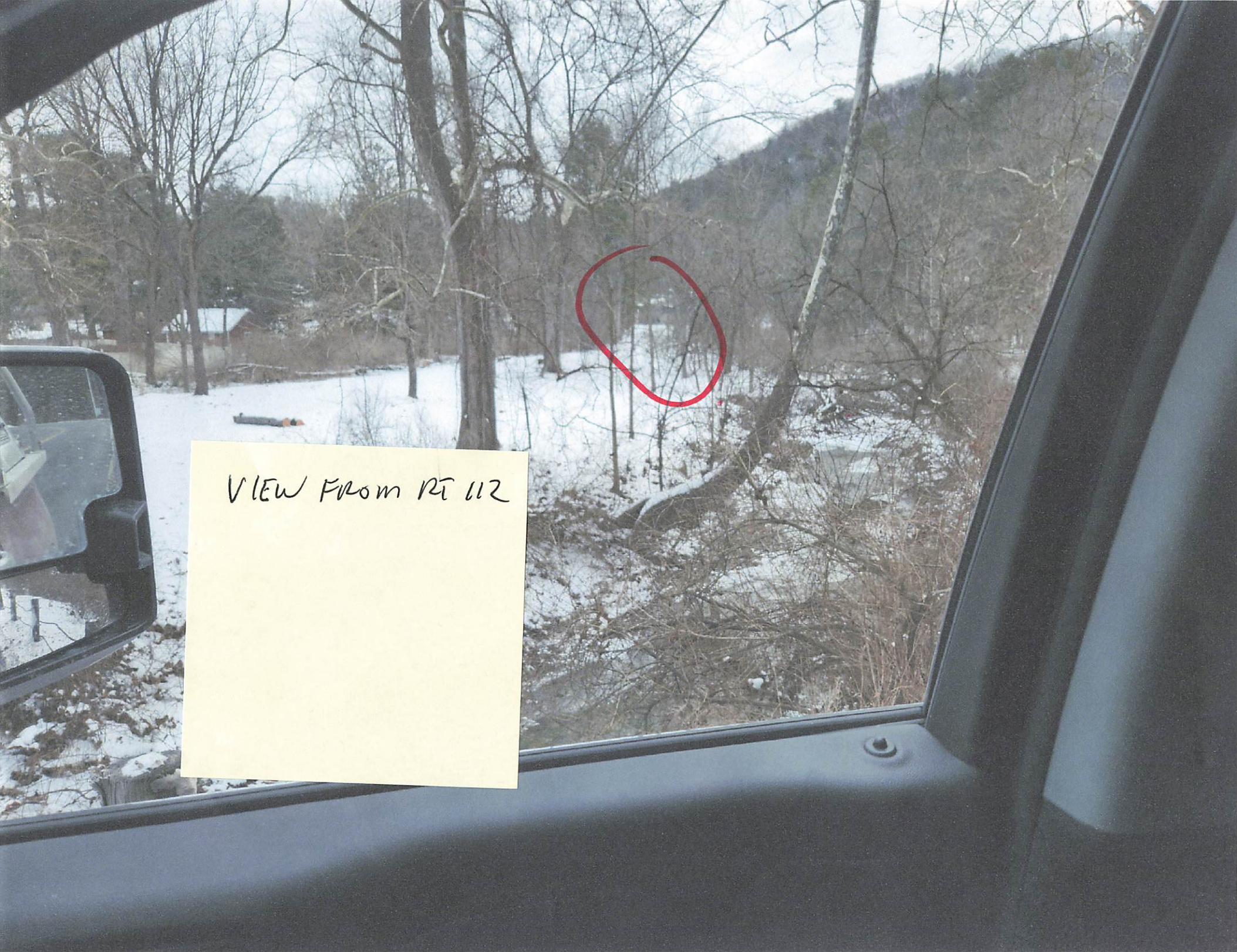

VIEW FROM RT 112

VIEW FROM RT 112
DRIVEWAY

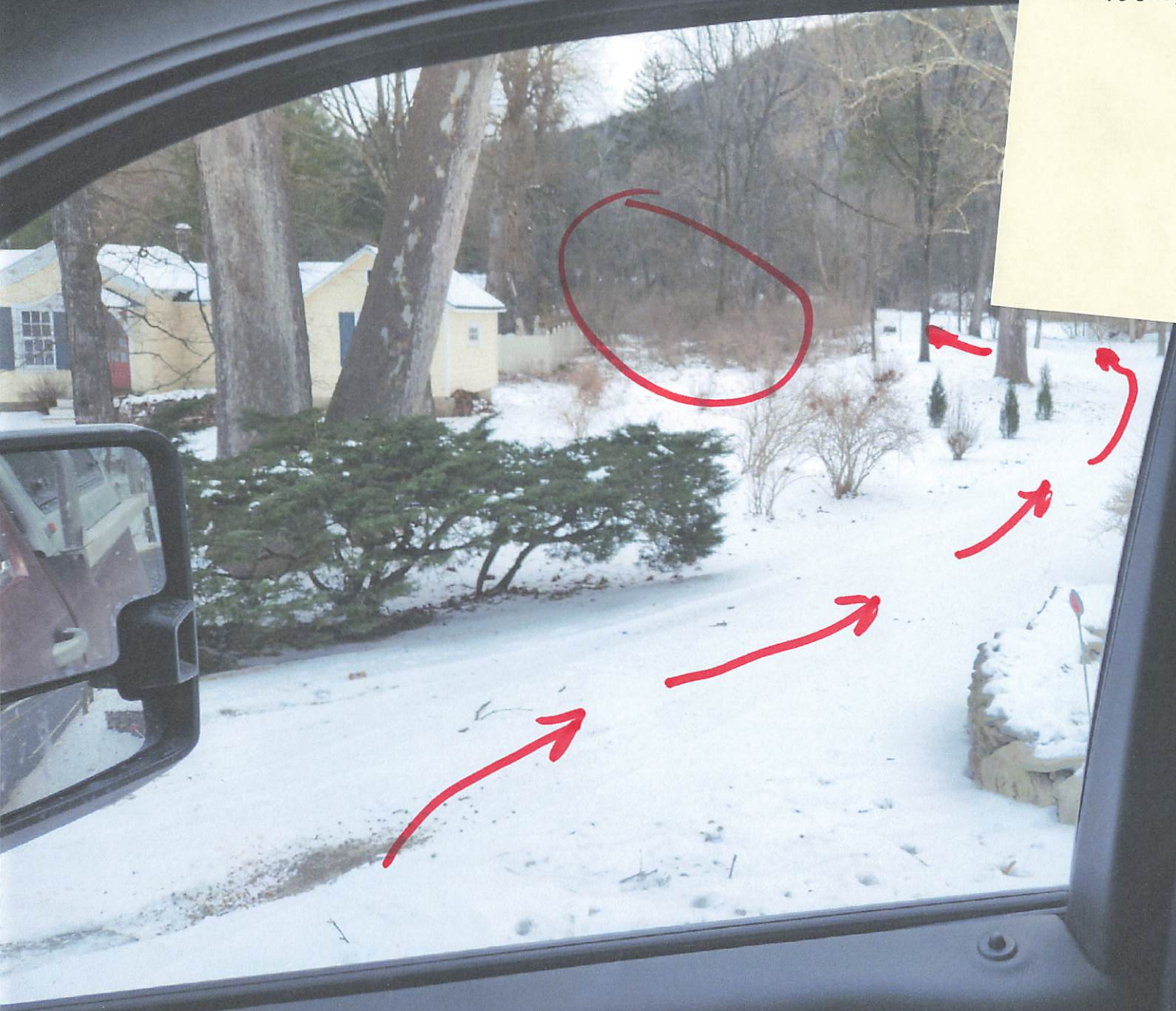

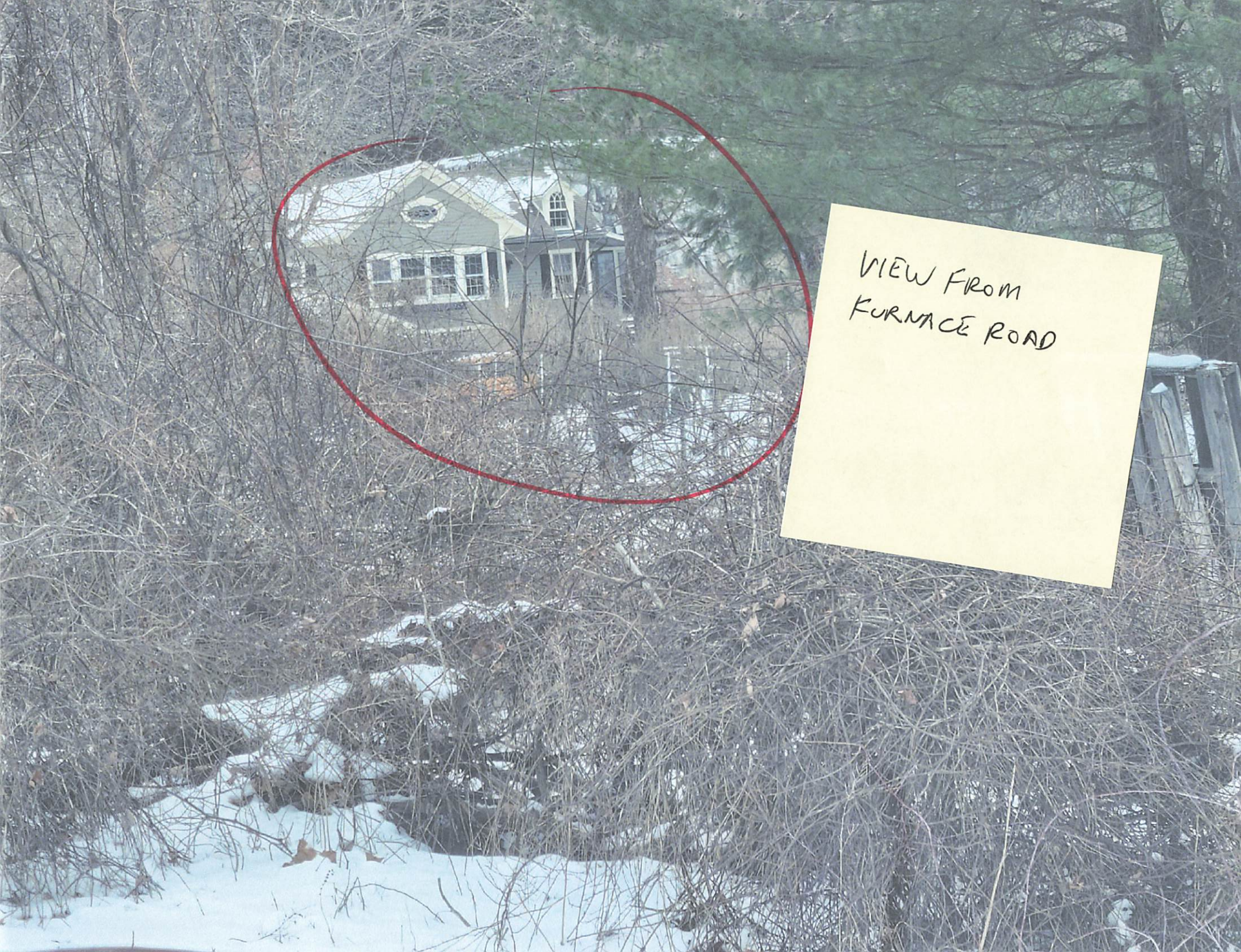
A photograph of a house seen through bare trees in winter. A red circle highlights the house. A yellow sticky note is placed on the right side of the image with handwritten text.

VIEW FROM
FURNACE ROAD

MODERN PORCH



MODERN ENERGY
PANELS





MODERN STORM
WINDOWS

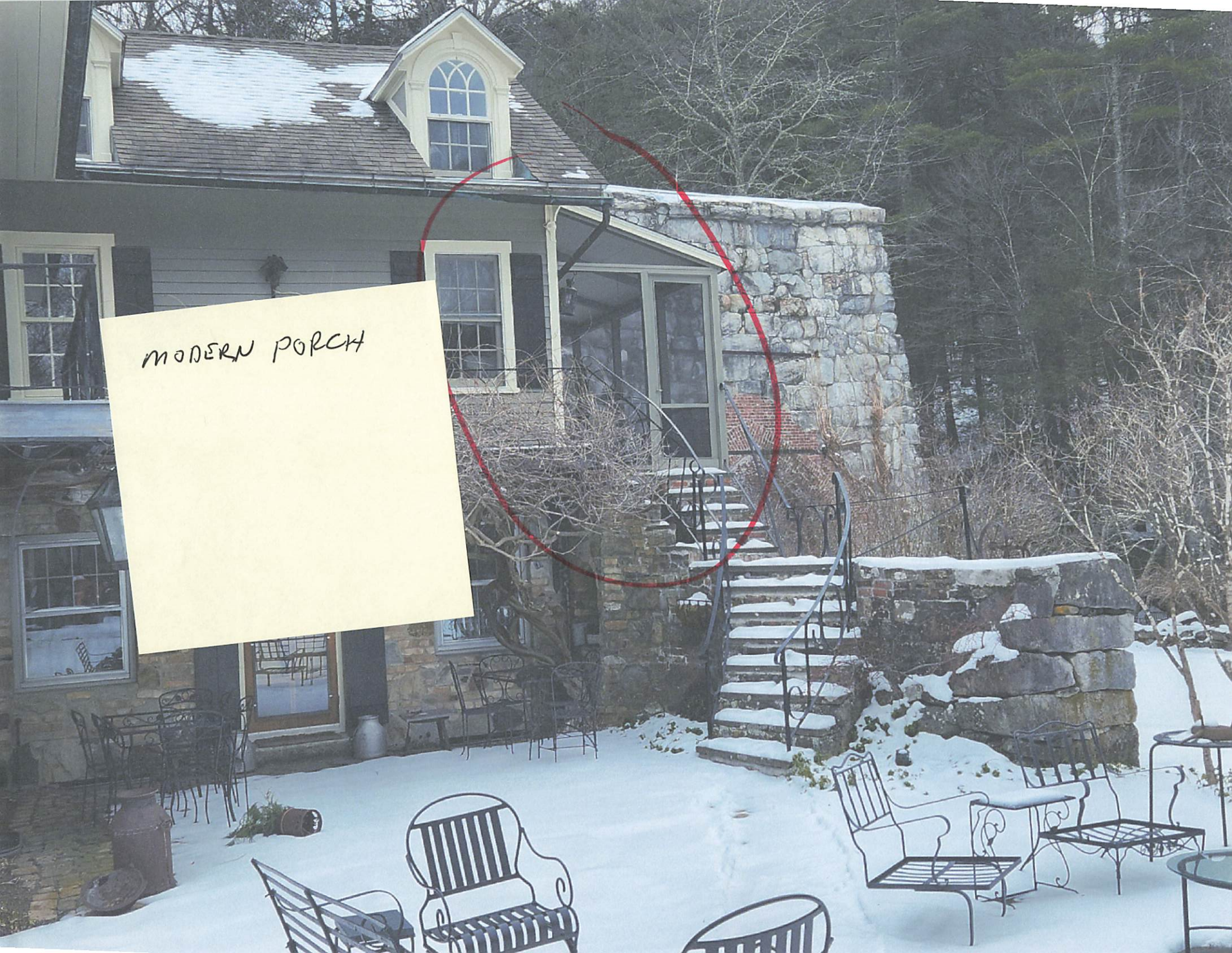

MODERN PORCH

MODERN STORM
WINDOWS



NEWER WINDOWS
WITH ENERGY PANELS

